

06-3 Magnetic Push Latches

Drill-in type magnetic push latch is a push-to-open solution for non-knob cabinet
Flexible mounting method on side, front or bottom panel

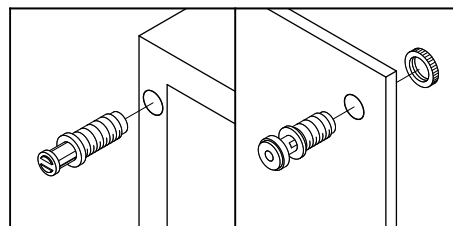

50880 Drill-In Type Magnetic Push Latch

- * Material: plastic
- * Color: black
- * 11mm hole drilling

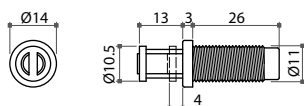

Item No.	Drilling hole
50880	11mm

50850 Drill-In Type Magnetic Push Latch

- * Material: plastic
- * Color: black, brown or white
- * 24mm C.C.
- * 15mm drilling hole
- * Mortise type

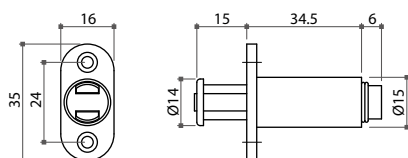

Item No.	C.C.	Drilling hole
50850	24mm	15mm