

# 11-3 Adjustable Floor Glides

## U-Bracket

- \* Steel material zinc plated
- \* Bottom hole M8 or M10 threaded, top hole Ø12.5mm
- \* With 4 chipboard screw holes
- \* To be used with adjustable glide, with bolt top slotted for adjustment by screw driver

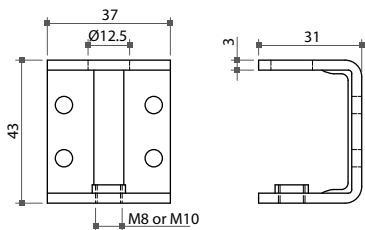

## MONTE CARLO, Ø35mm

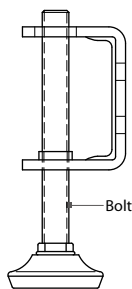

Model No.	Bolt size
UMO890	M8x90mm
UMO1080	M10x80mm
UMO1100	M10x100mm